

Rhythm HI-DEF

Equipment List

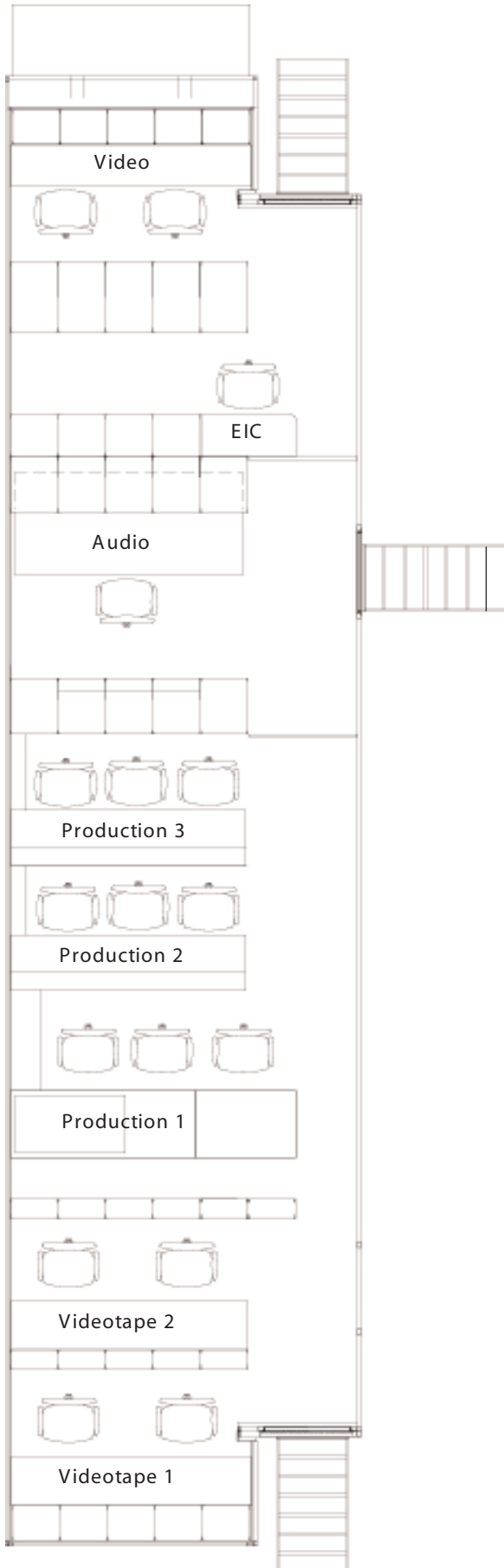

- 53-foot Trailer with 45-foot Expandable Side
- Grass Valley LDK-6000 MKII WORLDSCAM HD Cameras with Fujinon 101x1, 87x1 and 22x1 HD Lenses
- Grass Valley Kalypso 4-M/E 60-Input HD Production Switcher with 6 Built-in Channels of 2D Perspective Digital Video Effects
- Abekas DVEous MX Dual Twin-Channel HD/SD Digital Video Effects
- EVS XT[2] 4-Channel SpotBox
- Chyron Duet HyperX HD/SD Graphics System
- All HD & SD Tape-Machine Formats Available on Request
- EVS HD LSM XT[2] 6-Channel & 4-Channel Video Disk Recorders
- EVS HD RO XT[2] 4-Channel Video Disk Recorder
- EVS XFile XT[2] Digital Archive System
- SportNet SDTI 1-Gig Network
- Grass Valley Trinix 160x224 HD/SD Video Router
- Grass Valley Concerto 128X128 AES / 96x96 Analog Router
- 32x32 TC 64-Port Machine Control Router
- Calrec Sigma 100 BlueFin 160-Input 5.1 Digital Audio Console with 212-Channels (108-Stereo & 104-Mono with 64 Assignable Faders) and 8-VCA/Group Master Faders
- Dolby E 5.1 Stereo & DTS Neural Surround Sound Encoder/Decoders
- DigicartE Networked Audio Server
- RTS ADAM 96x96 Matrix Communications System
- Wide Range of Audio and Video Support Equipment
- Power Requirements 208-240 Volts
200 Amps Per Leg
3 Phase

Trio Video