

Tango HI-DEF

Equipment List

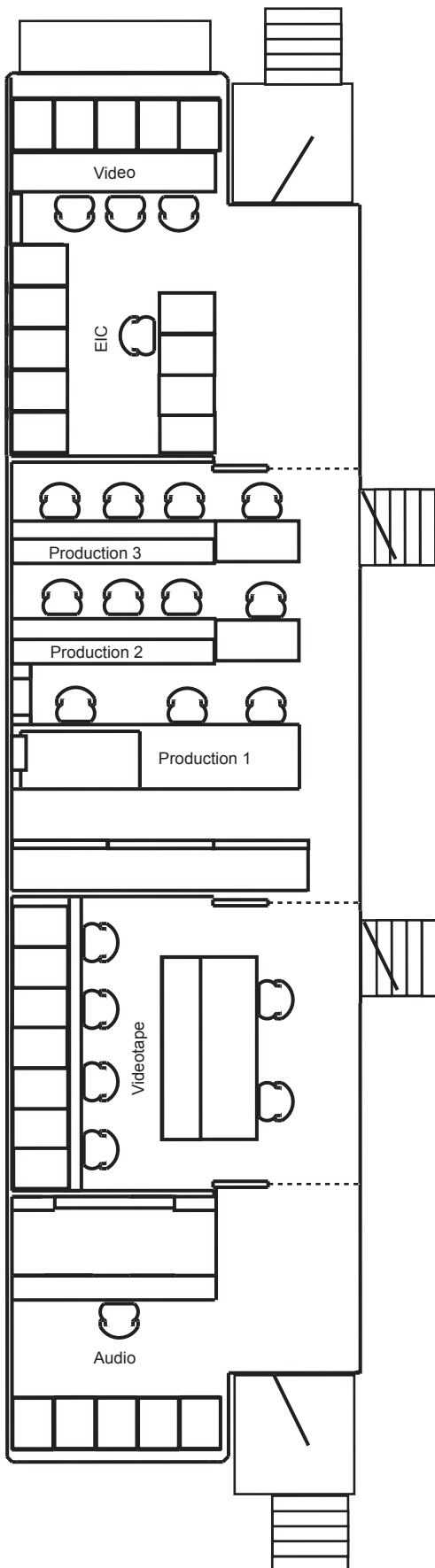

- 53-foot Trailer with 47-foot Expandable Side
- Grass Valley LDK-6000 MKII WORLD CAM HD Cameras with Fujinon 101x1, 87x1 and 22x1 HD Lenses
- Grass Valley Kalypso 4-M/E 90-Input HD Production Switcher with 6 Built-in Channels of 2D Perspective Digital Video Effects
- Accom DVEous MX Dual Twin-Channel HD/SD Digital Video Effects
- EVS XT[2] 4-Channel SpotBox
- Chyron Duet HyperX HD/SD Graphics System
- All HD & SD Tape-Machine Formats Available on Request
- EVS HD LSM XT[2] 6-Channel Video Disk Recorders
- EVS HD RO XT[2] 4-Channel Video Disk Recorder
- EVS XFile XT[2] Digital Archive System
- SportNet SDTI 1-Gig Network
- Grass Valley Trinix 256x256 HD/SD Video Router
- Grass Valley Concerto 192x192 AES / 128x128 Analog Audio Router
- Calrec Alpha 100 160-Input Digital Audio Console with 88-Channels (64-Stereo & 24-Mono with 48 Assignable Faders) and 8-VCA/Group Master Faders
- Dolby E 5.1 Stereo Surround Sound Encoder/Decoder
- Alesis 12R Audio Submixer
- Digicart II Plus with Zip Drives
- DBX-DDP Digital Audio Dynamic Processors
- RTS ADAM 128x128 Matrix Communications System
- Wide Range of Audio and Video Support Equipment
- Power Requirements 208-240 Volts
200 Amps Per Leg
3 Phase

Trio Video